

Wall Hanging variation one:

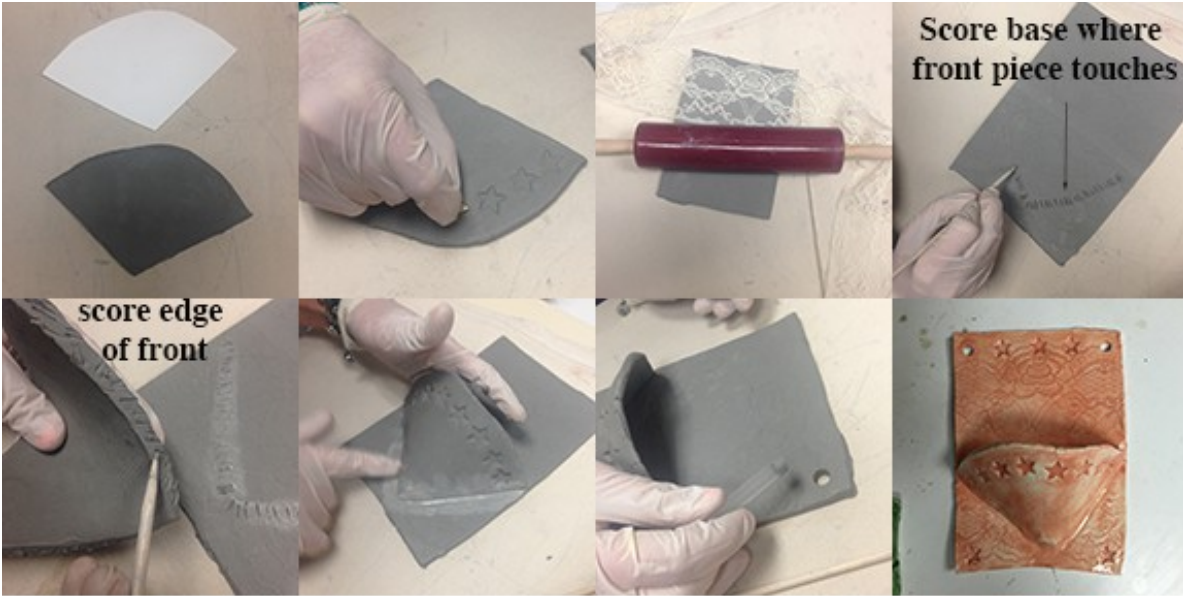

Wall Hanging variation two:

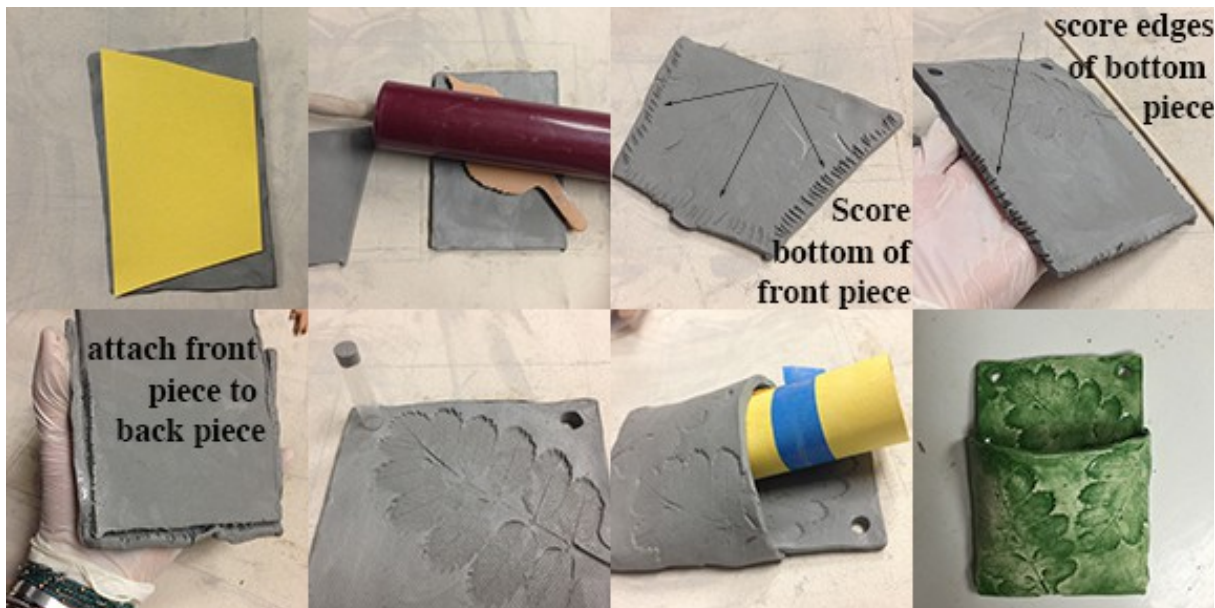

Sixth Grade Clay Project Wall Hanging Plant Holder

Supplies: sixth grade clay bin and clay supply shelves

- wooden skewers
- clay mats
- templates for front piece and back piece
- small bowls for water
- sponges (optional)
- impression objects such as lace, leaves, buttons (in art room)
- straws for punching holes

Prep:

- review clay guidelines
- Roll clay to 1/4 inch thick using the clay roller.
- Using needle tool or wooden skewer, slice pieces to fit selected templates

Students:

- Using needle tool or wooden skewer trace selected wall hanging template
- Carve name of student onto the back of the back piece using needle tool.
- Using wet finger or damp sponge, smooth out edges of clay pieces.
- Stamps, lace, rubber leaves or other objects can be used to make impressions on the clay back piece and front piece.
- Attach front piece to back piece, by scoring clay on both sides that will touch, and adding water with finger. Wiggle clay until they adhere to one another. Smooth clay using fingers.
- Variation one has a cone shape that attaches to the front side, while variation two attaches to the sides of the back.
- Wall hangings similar to variation two may need a roll of paper as support during drying process.

Glazing Option:

- The glaze in both variations was applied and then lightly wiped off so more remains in the impressions.

Resources:

For Full Photo Tutorial: <http://www.oliveandlove.com/?p=6391>